

# BHM

\*\*

Type of adaptor

**BMM** = male

**BMF** = female

**BFM** = in-line

**BHM** = ISO 4401 size 06

**BKM** = ISO 4401 size 10

Threated connections for BMM and BFM adaptors, see section 7

BHM and BKM adaptors, see section 7

**06** = G 1/4" (BMM, BMF, BFM)

**20** = G 3/4" (BFM)

**10** = G 3/8" (BMM, BFM)

**25** = G 1" (BFM)

**15** = G 1/2" (BMM, BFM)

**32** = G 1 1/4" (BFM)

**11** = port P

**14** = port B

**12** = port A and B

**17** = port P and A

**13** = port A

**18** = port P and B

## 7 DIMENSIONS OF ADAPTORS [mm]

**BMM - Male fittings:**

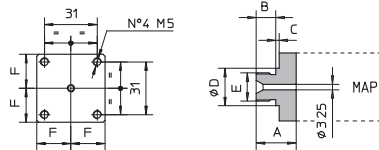

Weight: 0,3 Kg

**BMF - Female fittings:**

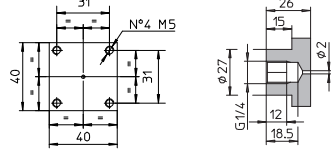

Weight: 0,8 Kg

	A	B	C	Ø D	E	F
<b>BMM-06</b>	22,5	11	1,5	18	G 1/4"	20
<b>BMM-10</b>	23,5	11,5	2	22	G 3/8"	20
<b>BMM-15</b>	27,5	15	2,5	26	G 1/2"	20

**BFM - In-line mounting:**

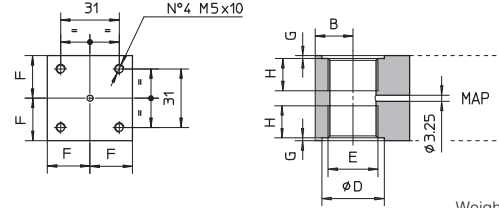

	A	B	Ø D	E	F	G	H
<b>BFM-06</b>	50	20	19	G 1/4"	22,5	1	12
<b>BFM-10</b>	50	20	23	G 3/8"	22,5	1	12
<b>BFM-15</b>	50	20	27	G 1/2"	22,5	1	15
<b>BFM-20</b>	50	20	33	G 3/4"	22,5	1,5	17
<b>BFM-25</b>	70	30	40	G 1"	30	1,5	19
<b>BFM-32</b>	70	30	50	G 1 1/4"	30	1,5	22

**BHM - Modular mounting surface ISO 4401-03-02-0-05**

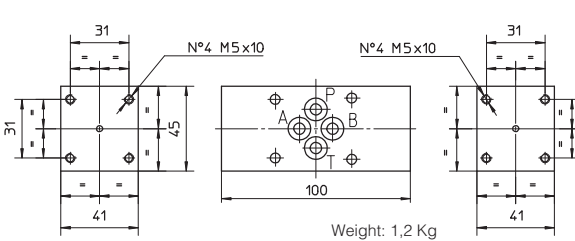

Weight: 1,2 Kg

**BKM - Modular mounting surface ISO 4401-05-03-0-05**

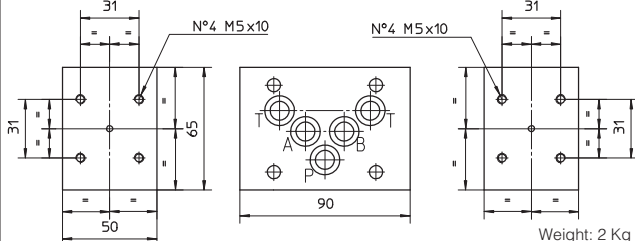

Weight: 2 Kg

For versions 11 and 13 the pressure switch is mounted on side of port A. For version 14 the pressure switch is mounted on side of port B. For versions 12, 17, 18 the pressure switch is mounted on both sides.