

TMA - Aluminum DRAIN PLUGS WITH MAGNET

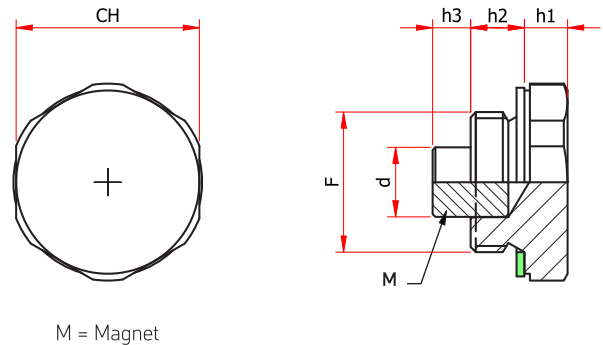
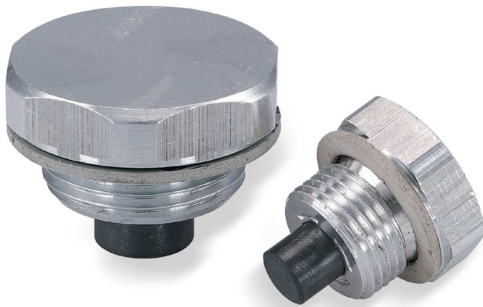

M = Magnet

-Hex plugs manufactured from aluminum, complete with fiber gasket (aluminum washer available as an option).
 -The plug is equipped with a pressed-in cylindrical magnet, located in the base of the plug.

-These plugs are fitted to the bottom of the tank, in order to collect ferrous particles that are floating in the oil, helping to protect pumps, valves and cylinders.

| Code | Ch | F | d | h1 | h2 | h3 |
|---------|----|----------|----|----|----|----|
| TMA/14 | 19 | G 1/4" | 5 | 7 | 10 | 6 |
| TMA/38 | 22 | G 3/8" | 8 | 7 | 10 | 7 |
| TMA/12 | 27 | G 1/2" | 10 | 8 | 10 | 7 |
| TMA/34 | 34 | G 3/4" | 13 | 8 | 10 | 7 |
| TMA/1 | 40 | G 1" | 13 | 8 | 14 | 7 |
| TMA/114 | 50 | G 1 1/4" | 10 | 10 | 15 | 15 |

KMF - BRASS FILLER PLUGS WITH FILTER

KMV - BRASS FILLER PLUGS WITH VENT VALVE



1 = Breather holes
 2 = Air filter
 3 = One-way check valve

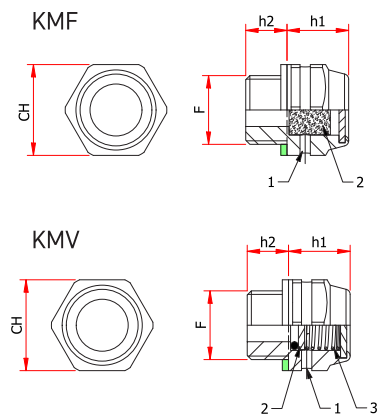

-Threaded metal plugs made from brass, fiber gasket (aluminum washer available on request).

-Two breather holes are located under the hex head, providing an adequate airflow capacity.

-KMF model is equipped with a metal filter (filtration degree around 200 microns), to avoid pollution of the oil.

-KMV model is used when venting of the reservoir is required only in case of internal over-pressurization.

- The pre-tensioned spring of the valve will allow the valve

disc to be lifted from its seat at a pressure of **0.35 bar/5 PSI**, thus allowing the air to escape; when the pressure is reduced after venting the valve will close and stop air to entering the tank. The vent valve, in closed position, prevent dust particles or other forms of contamination from the atmosphere to enter the oil.

-Extensively used in small oil tanks, gearboxes, gear reducers, torque multipliers and transmissions.

-Available on request made from stainless steel AISI 316.

| Code | F | Ch | h1 | h2 |
|---------------|--------|----|------|----|
| KMF/14 KMV/14 | G 1/4" | 18 | 15,5 | 9 |
| KMF/38 KMV/38 | G 3/8" | 22 | 14,5 | 10 |
| KMF/12 KMV/12 | G 1/2" | 27 | 14,5 | 10 |